

HISTORY

In 2002, 7000 trees were planted as part of the birthplace forest initiative. In 2007, a group of community volunteers developed the Oval Garden. Since that time the garden area has increased to include 21 individual gardens showcasing the variety of plants that grow in Calgary's unique climate.

The gardens are maintained by a group of dedicated volunteers who contribute over 8000 hours annually. To learn more visit www.bgss.ca

M Main Entrance
S South Entrance
21 Garden
 Forest Area
 Picnic Area
 Information
 Water Fountain
 Washroom
 Parking
 On leash area

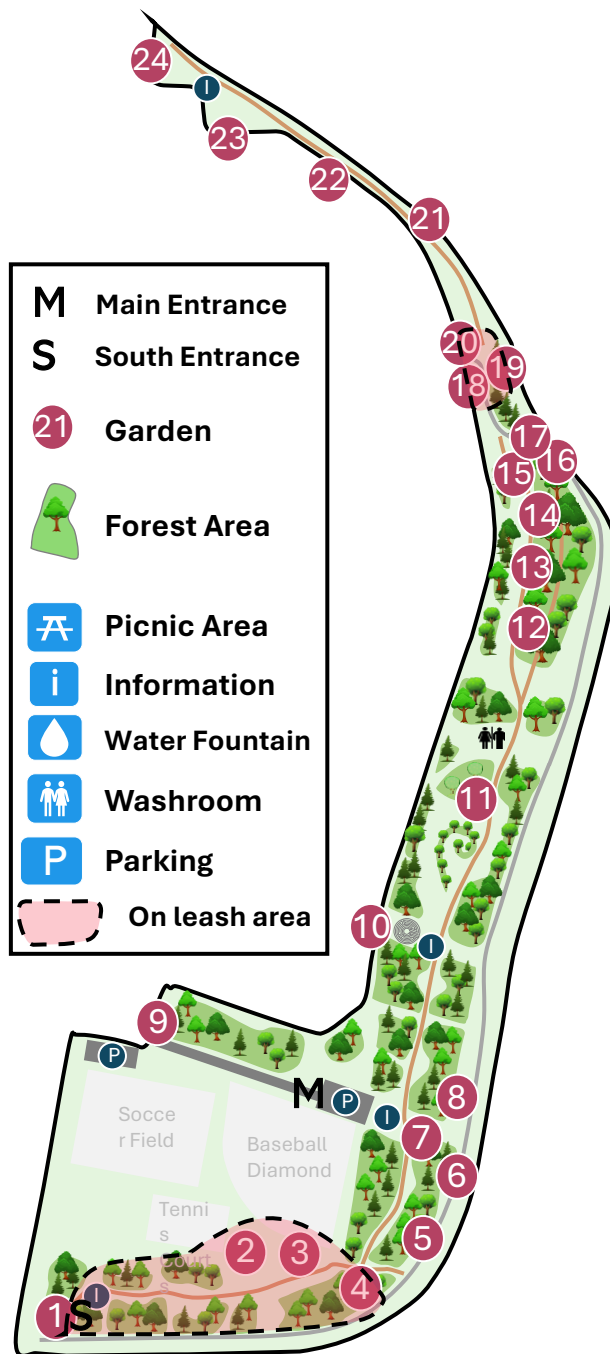

GARDEN LEGEND

- 1) Gateway Garden
- 2) Heart Garden & Picnic Grove
- 3) Oval Garden
- 4) Shade Garden
- 5) South Border Garden
- 6) Martagon Lily Garden
- 7) Welcome Garden
- 8) Prairie Celebration Rose Garden
- 9) Entrance Garden
- 10) Labyrinth
- 11) Fruit Grove
- 12) Eagle Garden
- 13) Owl Garden
- 14) Pelican Garden
- 15) Peony Garden
- 16) Swan Garden
- 17) Alpine Crevice & Native Plant Garden
- 18) Old Post Garden
- 19) LoH2O Garden
- 20) Rose Bowl
- 21) Wall Garden
- 22) Sunflower Garden
- 23) Shakespeare Garden
- 24) Half Moon Garden